

THIS SECTION OF ISLAND ROAD TO BE CLOSED TO THROUGH TRAFFIC

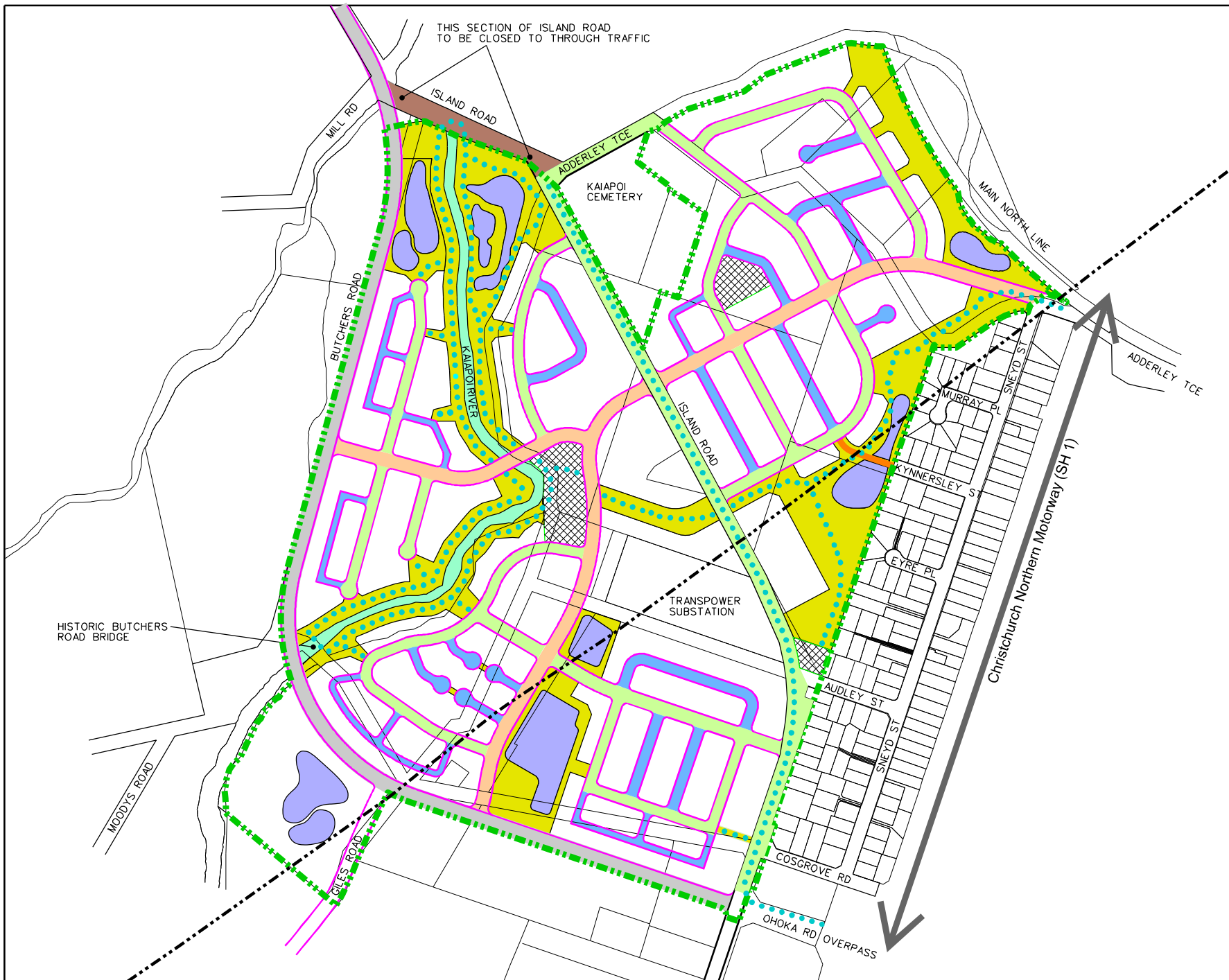

- OUTLINE DEVELOPMENT PLAN AREA
- EXISTING ROAD
- PROPOSED ROAD DESIGN
- LOCAL ROAD
- COLLECTOR ROAD
- NEIGHBOURHOOD ROAD
- ARTERIAL ROAD
- PEDESTRIAN CYCLEWAY NETWORK
- LOCAL / NEIGHBOURHOOD RESERVE
- RECREATION AND ECOLOGICAL LINKAGES
- STORMWATER MANAGEMENT AREA
- POSSIBLE FUTURE ROAD
- CHRISTCHURCH AIRPORT 50dBA NOISE CONTOUR

NOTE:  
Disclaimer - refer to map legend sheet

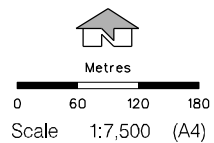

West Kaiapoi  
Outline Development Plan  
Movement Network & Open Space

**164B**