

Tuesday July 2, 2005

Media Release

Better Parking in the Pipeline for Main Street

The Waimakariri District Council is looking to fast track plans to further improve parking on Rangiora's main street.

Mayor, Jim Gerard, says the Council has long signalled its desire to upgrade parking along High Street to improve access and safety for motorists and pedestrians.

"We are conscious of the universal opposition to the right angled parking along the main street and believe the time is right to address these long-standing concerns."

Changes have already been made to the far end of High Street, which he says have been well received.

While the Council had not originally intended to embark on further parking changes until later this year, Jim Gerard says the positive feedback and current construction activity in the area suggests "there are a lot of benefits in pushing ahead with the rest of the work now, and completing the job 'all at once'".

The Council will be meeting with central business operators next week (Tuesday July 12th) to discuss additional works which would involve converting the length of High Street from Percival Street to Victoria Street into a one-way street heading east, and the installation of angle parking on both sides.

This would then provide an environment similar to what is now in place on High Street between Victoria Street and Ashley Street.

It is proposed at this stage to leave the right angle parking on the south side of High Street from Percival Street to the King Street roundabout where the traffic remains two-way, for safety and convenience reasons.

Utilities and Roading Manager, Don Young, says "the existing parking arrangement has long been a source of frustration for visitors to the centre of town, with the lack of visibility resulting in a lot of minor bumps and scrapes."

While motorists would still need to negotiate any new layout with care, he says, the proposed changes would provide safer, easier manoeuvring around town.

The Council acknowledges the need to also review off-street parking and the appearance of the town centre, and this will be done in due course as resources allow.

Don Young says, "It is also likely that areas such as Alfred Street behind the Farmers building might need changing. This would need to be done over time, however, whereas these proposed parking improvements would tidy the most troublesome areas, all in one go."

If the additional work does proceed, it is likely to begin in August.

For further information contact:

Don Young

Manager, Utilities and Roading

Phone: 03 313 6136

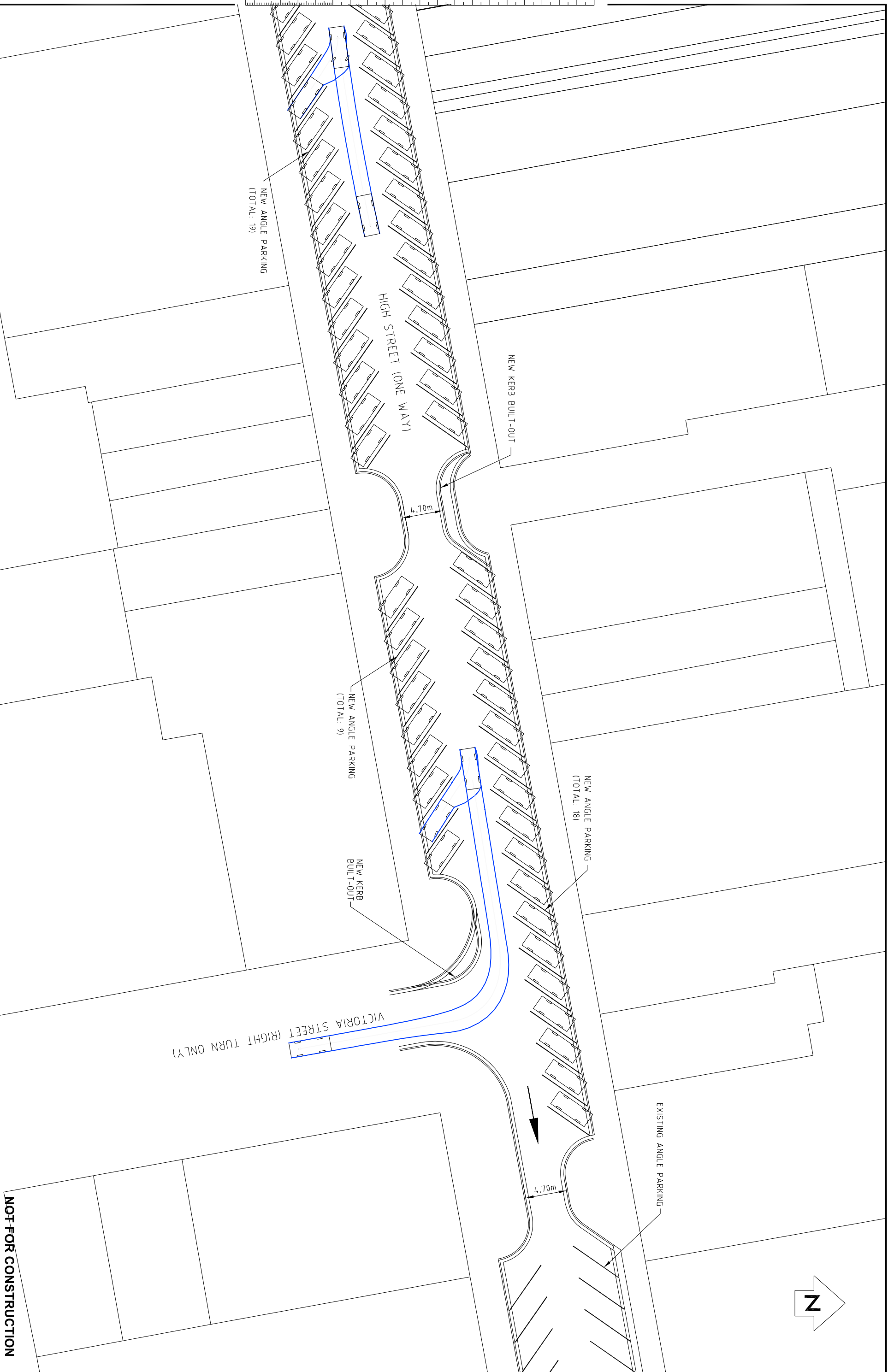

TAB/DWG: Sheet 2 / Parking Option 1.DWG SERVER: (CHRISTCHURCH NZCHKZ501)		SURVEYED: P. MURRAY DESIGNED: K. WILLIAMS DESIGN CHECK: P. MURRAY DRAWN: K. WILLIAMS DRAWING CHECK: K. WILLIAMS APPROVED:		None Date: 06.05 06.05 06.05 06.05 06.05	
XREFS:		None		None	
COPYRIGHT © These drawings shall only be used for the purpose for which they were supplied. Any reuse is prohibited and no part of this document may be reproduced or distributed without the written permission of MWH NZ Ltd.		MWH		WAIMAKARIRI CONSULTANTS	
RANGIORA HIGH STREET PARKING IMPROVEMENTS CONCEPT PLAN		NOT FOR CONSTRUCTION CONCEPTUAL		Status: Concept Date: 24/06/2005 Scale: 1:1200 Job No: 001691-64 Sheet No: C02 Rev: 1	
1 KERB BUILD-OUTS ADDED. PARKS REMOVED AMENDMENTS		INITIAL DATE CHECKED: 06.05 K.W. INITIAL DATE APPROVED:		INITIAL DATE APPROVED:	

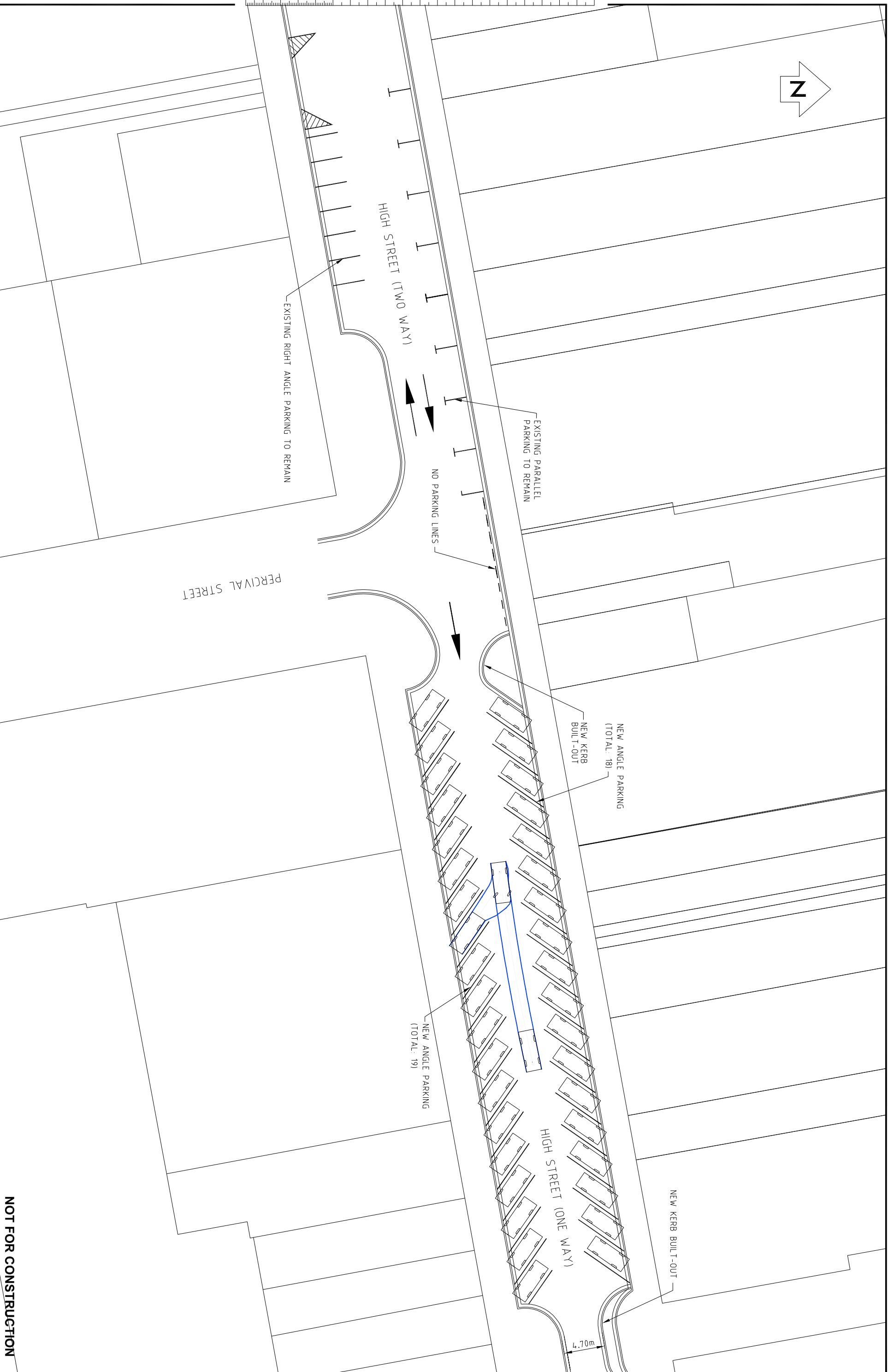
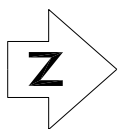

TAB/DWG: Sheet 1 / Parking Option 1.DWG SERVER: (CHRST)CHURCH (NZCHK2501)		SURVEYED: P. MURRAY DESIGNED: K. WILLIAMS DESIGN CHECK: P. MURRAY DRAWN: K. WILLIAMS DRAWING CHECK: K. WILLIAMS APPROVED: K. WILLIAMS		Name: P. MURRAY Date: 06.05 Name: K. WILLIAMS Date: 06.05 Name: P. MURRAY Date: 06.05 Name: K. WILLIAMS Date: 06.05						RANGIORA HIGH STREET PARKING IMPROVEMENTS CONCEPT PLAN		NOT FOR CONSTRUCTION STATUS: CONCEPTUAL Date Stamp: 24/06/2005 SCALES (A1): 1:200 Job No.: 001691-64 Sheet No.: C01 Rev.: 1	
1 KERB BUILD-OUTS ADDED. PARKS REMOVED		ARGUMENTS:		INITIAL DATE CHECKED: 06.05 K.W. INITIAL DATE APPROVED:		COPYRIGHT © These drawings shall only be used for the purpose for which they were supplied. Any reuse is prohibited and no part of this document may be reproduced or distributed without the written permission of MWH NZ Ltd.							